

NOTICE!!

These documents have been scanned!

Do not place un-scanned documents beneath this notice!

Do not remove this notice from this file!

GPO Jacket No. 560-102
Print Order 61540
Rise Business Services, LLC
Job=AZ15 7/11/2019



Box Number= AZ15155



Claim Begin-End: AMC452381-AMC452383

1 Initial Receipt



AZ15155-9

AMC452349-AMC452348

United States Department of the Interior
Bureau of Land Management
 DIV OF LANDS, MINRLS & ENERGY
 ONE N CENTRAL AVE
 PHOENIX, AZ 85004 -4427
 Phone: 602-417-9200

Receipt

No: 4301947

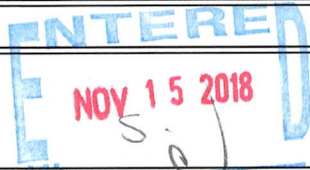
Transaction #: 4418187	
Date of Transaction: 11/07/2018	
CUSTOMER:	
NOAH GORDON PO BOX 800 CONGRESS, AZ 85332-0800 US	

LINE #	QTY	DESCRIPTION	REMARKS	UNIT PRICE	TOTAL
1	3.00	LOCATABLE MINERALS / MINING CLAIMS-NEW, UNADJUD, ONE OR MORE AUTH NOS / NEW MINING CLAIM PROCESSING FEE CASES: AMC452381/\$20.00, AMC452382/\$20.00, AMC452383/\$20.00		- n/a -	60.00
2	3.00	LOCATABLE MINERALS / MINING CLAIMS-NEW, UNADJUD, ONE OR MORE AUTH NOS / NEW MINING CLAIMS LOCATION FEE CASES: AMC452381/\$37.00, AMC452382/\$37.00, AMC452383/\$37.00		- n/a -	111.00
3	3.00	LOCATABLE MINERALS / MINING CLAIMS-NEW, UNADJUD, ONE OR MORE AUTH NOS / NEW MINING CLAIMS MAINTENANCE FEE CASES: AMC452381/\$155.00, AMC452382/\$155.00, AMC452383/\$155.00		- n/a -	465.00
TOTAL:					\$636.00

PAYMENT INFORMATION			
NOTE: Items will appear on credit card statement as "Bureau of Land Mgmt CO".			
1	AMOUNT:	636.00	POSTMARKED: N/A
	TYPE:	CREDIT CARD	RECEIVED: 11/07/2018
	NAME:	GORDON, NOAH PO BOX 800 CONGRESS AZ 85332-0800 US	
	CARD NO:	XXXXXXXXXXXX1251	AUTH CODE: 047919
		NOAH GORDON	

	NAME ON CARD:	
	SIGNATURE:	

REMARKS

This receipt was generated by the automated BLM Collections and Billing System and is a paper representation of a portion of the official electronic record contained therein.

NOTICE!!

These documents have been scanned!

Do not place un-scanned documents beneath this notice!

Do not remove this notice from this file!

GPO Jacket No. 560-102
Print Order 61540
Rise Business Services, LLC
Job=AZ15 7/11/2019



Box Number= AZ15155



Claim Begin-End: AMC452381-AMC452383

2 Correspondence



AZ15155-9

AMC452349-AMC452348



United States Department of the Interior



BUREAU OF LAND MANAGEMENT
Arizona State Office
One North Central Avenue, Suite 800
Phoenix, Arizona 85004-4427
www.blm.gov/az/

JUL 08 2020

In Reply Refer To:
3800 (9200) RM
AMC452831

CERTIFIED MAIL - RETURN RECEIPT REQUESTED No. 9214 8901 9403 8315 7797 85

DECISION

DANIEL AND NICOLE RADEV	:	This Decision Affects the Claim(s)
137 KINDER LN	:	Shown in the Block Below.
GRANITE CITY, IL 62040-2826	:	

AMC452849
X BAR G INDIAN CREEK

Mining Claim(s) Declared Forfeited Required Amendment Not Filed

In accordance with 43 CFR 3830.94, the mining claim(s) listed above are hereby declared forfeited for the reason indicated below.

A Notice requiring that the claim(s) listed above be amended was mailed to the above address by certified mail. The amendment(s) were required to be filed within 30 days of the date the Notice was either received or returned to this office unclaimed or undeliverable. The 30 day timeframe allowed has expired and no amendment(s) were received within the allowed timeframe.

This decision does not relieve you of the liability for reclamation of all areas disturbed by your activities on land encompassed by your mining claim(s) and/or site(s). After you complete the reclamation, you must notify the authorized officer of the appropriate surface managing agency so that the authorized officer may conduct a final site inspection and determine whether you may

be released from liability. If you fail to reclaim the land to the satisfaction of the authorized officer, the surface management agency may cite you for noncompliance under its surface management regulations.

For land administered by the Bureau of Land Management (BLM), if you fail to reclaim the land to the satisfaction of the authorized officer as required in 43 CFR Subpart 3809, the BLM will issue an order of noncompliance under 43 CFR 3809.601(a). If you fail to comply with the noncompliance order, the BLM may take further action under 43 CFR 3809.604. Failure to conduct reclamation is a prohibited act that may subject you to criminal penalties. See 43 CFR 3809.605(h) and 43 CFR 3809.700. If your occupancy has been terminated and you fail to remove structures, material, and equipment, and any personal property in accordance with the regulations in 43 CFR 3715.5-1, the BLM may dispose of the property. In accordance with 43 CFR 3715.5-2, you will remain liable for the costs the BLM incurs in removing and disposing of the property.

Appeal Procedures

This decision may be appealed to the Interior Board of Land Appeals, Office of the Secretary, in accordance with the regulations contained in 43 CFR, Part 4 and the enclosed Form 1842-1. If an appeal is taken, your notice of appeal must be filed in this office (at the above address) within 30 days from receipt of this decision. The appellant has the burden of showing that the decision appealed from is in error.

If you wish to file a petition pursuant to regulation 43 CFR 4.21 (58 FR 4939, January 19, 1993), for a stay of the effectiveness of this decision during the time that your appeal is being reviewed by the Board, the petition for a stay must accompany your notice of appeal. A petition for a stay is required to show sufficient justification based on the standards listed below. Copies of the notice of appeal and petition for a stay must also be submitted to each party named in this decision and to the Interior Board of Land Appeals and to the appropriate Office of the Solicitor (see 43 CFR 4.413) at the same time the original documents are filed with this office. If you request a stay, you have the burden of proof to demonstrate that a stay should be granted.

Standards for Obtaining a Stay

Except as otherwise provided by law or other pertinent regulation, a petition for a stay of a decision pending appeal shall show sufficient justification based on the following standards:

- (1) The relative harm to the parties if the stay is granted or denied,
- (2) The likelihood of the appellant's success on the merits,
- (3) The likelihood of immediate and irreparable harm if the stay is not granted, and
- (4) Whether the public interest favors granting the stay.

If additional information is required, please contact RéAnn Myers at 602-417-9413. Please include your AMC serial number(s) on all correspondence.



Elena Fink
Deputy State Director
Lands, Minerals and Energy Division



Enclosure

Date Produced: 07/20/2020

ConnectSuite Inc.:

The following is the delivery information for Certified Mail™/RRE item number 9214 8901 9403 8315 7797 85. Our records indicate that this item was delivered on 07/13/2020 at 10:58 a.m. in GRANITE CITY, IL 62040. The scanned image of the recipient information is provided below.

Signature of Recipient :

Signature X		
Printed Name	Daniel Radev	

Address of Recipient :

Delivery Address	137 Kinder Ln	
---------------------	---------------	---

Thank you for selecting the Postal Service for your mailing needs. If you require additional assistance, please contact your local post office or Postal Service representative.

Sincerely,
United States Postal Service

The customer reference number shown below is not validated or endorsed by the United States Postal Service. It is solely for customer use.

Customer Reference Number: C2146650.12208217



United States Department of the Interior



BUREAU OF LAND MANAGEMENT
Arizona State Office
One North Central Avenue, Suite 800
Phoenix, Arizona 85004-4427
www.blm.gov/az/

APR 17 2020

In Reply Refer To:
3800 (9200) RM
AMC452831

CERTIFIED MAIL - RETURN RECEIPT REQUESTED No. 9214 8901 9403 8310 9832 62

NOTICE

DANIEL AND NICOLE RADEV : This Notice Affects the Claim(s)
137 KINDER LN : Shown in the Block Below.
GRANITE CITY, IL 62040-2826 :

AMC452849
X BAR G INDIAN CREEK

Mining Claim Location Notice(s) – Amendment(s) Required

Pursuant to Title 43 Code of Federal Regulations (CFR) 3832.1, the Bureau of Land Management (BLM), Arizona State Office, received your notice(s) of location for recording mining claims. In accordance with 43 CFR 3832.12, the claim(s) listed above cannot be accepted as filed and must be amended as noted below.

The claim is an irregular shape. You must describe placer claims by aliquot part and complete lots using the U.S. Public Land Survey System and its rectangular subdivisions (i.e., a 40 acre claim would be 1,320 x 1320). In all cases, the description must be as compact and regular in form as possible.

In accordance with 43 CFR 3832.12(c) (1) You must describe placer claims by aliquot part and complete lots using the U.S. Public Land Survey System and its rectangular subdivisions except when placer claims are (i) on unsurveyed Federal lands; (ii) Gulch or bench placer claims; or (iii) Bounded by other mining claims or non-mineral lands. If one of these situations exists, you must describe the lands by protracted survey or by metes and bounds. In all cases, your description of the land must be as compact and regular in form as reasonably possible and should conform to the U.S. Public Land Survey System and its rectangular subdivisions as much as possible.

The amendment(s) must provide one of the following:

1. Identify which situation exists that requires this placer mining claim to be located by metes and bounds and provide a metes and bounds description. If you believe the claim is a gulch placer, please provide a) a topographical map and b) the % steepness of the slope. A gulch placer is located on the bed of a river contained within steep, non-mineral canyon walls and the slope should be greater than 60%.
2. Amend the mining claim using the U.S. Public Land Survey System and its rectangular subdivisions and describe the mining claim by aliquot parts and complete lots.

Keep in mind that when amending a mining claim, no new ground can be taken in. A placer mining claim must contain at least 10 acres. Therefore, an amended claim would have to contain at least 10 acres and must be described by aliquot parts. If this cannot be achieved, the claim should be relinquished and a new claim located correctly, rather than amending an incorrectly located claim.

If you are able to correctly amend the claim(s) listed above and decide to do so, there is a \$15 BLM processing fee for each amendment. The amendment(s) must be received by BLM within 30 days of your receipt of this notice. If the amendment(s) is/are not received within the 30-day timeframe the mining claim(s) will be declared null and void ab initio.

If additional information is required, please contact RéAnn Myers at 602-417-9413. Please include your AMC serial number(s) on all correspondence.



Elena Fink
Deputy State Director
Lands, Minerals and Energy Division

Enclosure(s)

Date Produced: 04/27/2020

ConnectSuite Inc.:

The following is the delivery information for Certified Mail™/RRE item number 9214 8901 9403 8310 9832 62. Our records indicate that this item was delivered on 04/25/2020 at 10:47 a.m. in GRANITE CITY, IL 62040. The scanned image of the recipient information is provided below.

Signature of Recipient :

Delivery Section	
Delivered	X COVID-19
Delivered Name	TAS 40 04/25/20

Address of Recipient :

Delivery Address	137 Kinder Ln
------------------	---------------

Thank you for selecting the Postal Service for your mailing needs. If you require additional assistance, please contact your local post office or Postal Service representative.

Sincerely,
United States Postal Service

The customer reference number shown below is not validated or endorsed by the United States Postal Service. It is solely for customer use.

Customer Reference Number: C2031188.11574448

NOTICE!!

These documents have been scanned!

Do not place un-scanned documents beneath this notice!

Do not remove this notice from this file!

GPO Jacket No. 560-102
Print Order 61540
Rise Business Services, LLC
Job=AZ15 7/11/2019



Box Number= AZ15155



Claim Begin-End: AMC452381-AMC452383

3 Transfers



AZ15155-9

AMC452349-AMC452348

452381

TO: UNITED STATES DEPARTMENT OF THE INTERIOR
BUREAU OF LAND MANAGEMENT
ONE N. CENTRAL AVE SUITE 800
PHOENIX, AZ, 85004-4427

March 13th, 2019

NOTICE OF CHANGE IN OWNERSHIP OF MINING CLAIM

This letter and enclosed quitclaim deed, and check for the \$15. transfer fee, serves as notice that the:

AMC 452381 Crazy Horse

unpatented mining claim was transferred to the new owner:

James Trollinger
729 W. Coolidge St. #213
Phoenix, AZ
85013

by instrument of quitclaim deed.

RECEIVED
BLM #27 STATE OFFICE
2019 MAR 15 P 1:39
PHOENIX, ARIZONA

Sincerely,

Noah Gordon

Enclosed:
Notification letter
Quitclaim deed
Transfer fee of \$15.

4400280

ENTERED
MAR 27 2019
By: Ram

When recorded, mail to:

Name: James Trollinger

Address: 729 W. Coolidge St. #213

City/State/Zip Code: Phoenix, AZ, 85013

Space above this line for Recorder's use

QUITCLAIM DEED

KNOW ALL MEN BY THESE PRESENTS:

That I(we), Noah Gordon,
the undersigned, for the consideration of Ten Dollars (\$10.00), and other valuable considerations, do
hereby release, remise, and forever quitclaim unto James Trollinger

all right, title and interest in that certain Property situated in Yavapai County,
State of Arizona, and described as follows:

**the unpatented federal mining claim AMC452381 Crazy Horse
as recorded in doc # 2018-0056918 in the Yavapai County Recorder's Office
located in the E1/2 SE1/4 SE1/4 SEC. 10 T8N R5W, GSRB&M, AZ**

RECEIVED
LM AZ STATE REC'D
2019 MAR 15 P 1:39
PHOENIX, ARIZONA

**NO TRANSFER NECESSARY
EXEMPT UNDER ARS 11-1134
A6**

IN WITNESS WHEREOF, I(we) have hereunto set my(our) hand(s) and seal this 13TH day of
March, 2019.

Noah Gordon
Printed Name of Releasor

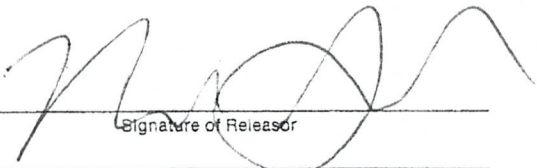
Signature of Releasor

Printed Name of Releasor

Signature of Releasor

Printed Name of Witness (if required by State Laws)

Signature of Witness (if required by State Laws)

ACKNOWLEDGMENT
(States Other Than California)

State of Arizona)
County of Maricopa) ss.

On this 13 day of March, 2019, before me, the undersigned
Notary Public, personally appeared Noah Gordon

known to me to be the individual(s) who executed the foregoing instrument and acknowledged the same
to be his(her)(their) free act and deed.

My Commission Expires: 7/23/22 
Notary Public



RECEIVED
BLM AZ STATE OFFICE
2019 MAR 15 P 1:39
PHOENIX, ARIZONA

NOAH GORDON
P.O. Box 800
CONGRESS, AZ
85332

PHOENIX AZ 852

14 MAR 2019 PM 10 L

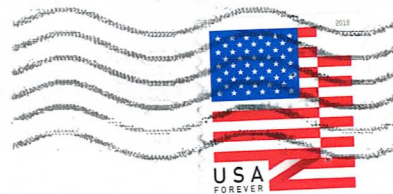

BUREAU OF LAND MANAGEMENT
ONE N. CENTRAL AVE SUITE #800
PHOENIX, AZ
85004-4427

PHOENIX, ARIZONA

2019 MAR 15 P 1:39

RECEIVED
BLM AZ STATE OFFICE

85004-442700



United States Department of the Interior
Bureau of Land Management
 DIV OF LANDS, MINRLS & ENERGY
 ONE N CENTRAL AVE
 PHOENIX, AZ 85004 -4427
 Phone: 602-417-9200

Receipt

No: 4400280

Transaction #: 4518726	
Date of Transaction: 03/19/2019	
CUSTOMER:	
	NOAH GORDON PO BOX 800 CONGRESS, AZ 85332-0800 US

LINE #	QTY	DESCRIPTION	REMARKS	UNIT PRICE	TOTAL
1	1.00	LOCATABLE MINERALS / MINING CLAIMS- NOT NEW-UNADJUD, ONE AUTH NO. ONLY / MINING CLAIM MONEY RECEIVED CASES: AMC452381/\$15.00	TRF/1	- n/a -	15.00
TOTAL:					\$15.00

PAYMENT INFORMATION					
1	AMOUNT:	15.00	POSTMARKED:	N/A	
	TYPE:	CHECK	RECEIVED:	03/15/2019	
	CHECK NO:	225			
	NAME:	GORDON, NOAH PO BOX 800 CONGRESS AZ 85332-0800 US			

REMARKS	

This receipt was generated by the automated BLM Collections and Billing System and is a paper representation of a portion of the official electronic record contained therein.

NOTICE!!

These documents have been scanned!

Do not place un-scanned documents beneath this notice!

Do not remove this notice from this file!

GPO Jacket No. 560-102
Print Order 61540
Rise Business Services, LLC
Job=AZ15 7/11/2019



Box Number= AZ15155



Claim Begin-End: AMC452381-AMC452383

4 Annual Filings



AZ15155-9

AMC452349-AMC452348

DEPARTMENT OF THE INTERIOR
BUREAU OF LAND MANAGEMENT
MINING CLAIMS

Run Date/Time: 9/24/2020

MC Maintenance Fees Paid Through the BLM Pay Portal
(by Date Paid)

Page 1 Of 1

CBS Receipt: 4770839

Printed For Lead File # AMC452381

Agency Tracking ID: 1595956179

Assessment Year: 2021

Number of BLM Serial Nr: 1

Paid On: 7/28/2020

Total Amount Paid:\$165.00

Message: :

Claim Name	BLM Serial No	Lead File No	Amount Paid
GOLD RUSH	AMC452383	AMC452381	\$165.00

United States Department of the Interior
Bureau of Land Management
 BUSINESS & SUPPORT SVCS DIV
 ONE N CENTRAL AVE SUITE 800
 PHOENIX, AZ 85004 -4427
 Phone: 602-417-9200

Receipt	
No:	4770839

Transaction #: 4897652	
Date of Transaction: 07/28/2020	
CUSTOMER:	
	JIM GENZ 2523 COUNTY RD 18 HARRISBURG,NE 69345 US

LINE #	QTY	DESCRIPTION	REMARKS	UNIT PRICE	TOTAL
1	1.00	LOCATABLE MINERALS / MINING CLAIMS- NOT NEW-UNADJUD,ONE AUTH NO. ONLY / MINING CLAIM MONEY RECEIVED CASES: AMC452383/\$165.00		- n/a -	165.00
TOTAL:					\$165.00

PAYMENT INFORMATION			
NOTE: Items will appear on credit card statement as "BLM O Mining Claim".			
1	AMOUNT:	165.00	POSTMARKED: N/A
	TYPE:	CREDIT CARD	RECEIVED: 07/28/2020
	NAME:	JIM GENZ 2523 COUNTY RD 18 HARRISBURG NE 69345 US	
	CARD NO:	XXXXXXXXXXXX6743	AUTH CODE: 004031
	NAME ON CARD:	JIM GENZ	
	SIGNATURE:	INTERNET	

REMARKS

This receipt was generated by the automated BLM Collections and Billing System and is a paper representation of a portion of the official electronic record contained therein.

AMC452381

UNITED STATES
DEPARTMENT OF THE INTERIOR
BUREAU OF LAND MANAGEMENT

CREDIT CARD PAYMENT
For Mining Claim Maintenance Fee

THIS IS A CHANGE OF ADDRESS

TELEPHONE SUBMISSION - ACCURACY OF THE BELOW INFORMATION IS THE RESPONSIBILITY OF THE CLAIMANT/OWNER

NAME JIM GENZ
ADDRESS 2523 COUNTY ROAD 18
CITY HARRISBURG STATE NE ZIP 69345
PHONE # 308 - 436-8300 / C-307-534-5594

SEND RECEIPT TO Above address
 Other (Include Name and Mailing Address):

AMC NUMBER 452383 CLAIM/SITE NAME GOLD RUSH

1 # of Claim/Site
x 165.00 Each
\$ 165.00 Total Charged EG (INITIALS)

RECEIPT # 4514953

DATE STAMP

RECEIVED
STATE OFFICE
2019 JUL 24 P 1:02
PHOENIX, ARIZONA

**** FOR OFFICIAL USE ONLY ****

DATE _____ INITIALS _____ VERIFIED _____

ENTERED INTO COMPUTER

7/25/19 MB

**United States Department of the Interior
Bureau of Land Management**
DIV OF LANDS, MINRLS & ENERGY
ONE N CENTRAL AVE
PHOENIX, AZ 85004 -4427
Phone: 602-417-9200

Receipt

No: 4514953

Transaction #: 4635540	
Date of Transaction: 07/24/2019	
CUSTOMER:	
JIM GENZ 2523 COUNTY RD 18 HARRISBURG, NE 69345 US	

LINE #	QTY	DESCRIPTION	REMARKS	UNIT PRICE	TOTAL
1	1.00	LOCATABLE MINERALS / MINING CLAIMS- NOT NEW-UNADJUD, ONE AUTH NO. ONLY / MINING CLAIM MONEY RECEIVED CASES: AMC452383/\$165.00	2020 MAINT (1)	- n/a -	165.00
TOTAL:					\$165.00

PAYMENT INFORMATION			
NOTE: Items will appear on credit card statement as "Bureau of Land Mgmt CO".			
1	AMOUNT:	165.00	POSTMARKED: N/A
	TYPE:	CREDIT CARD	RECEIVED: 07/24/2019
	NAME:	GENZ, JIM 2523 COUNTY RD 18 HARRISBURG NE 69345 US	
	CARD NO:	XXXXXXXXXXXX6743	AUTH CODE: 005232
	NAME ON CARD:	JIM GENZ	
	SIGNATURE:	OVER THE PHONE	

REMARKS

This receipt was generated by the automated BLM Collections and Billing System and is a paper representation of a portion of the official electronic record contained therein.

UNITED STATES
DEPARTMENT OF THE INTERIOR
BUREAU OF LAND MANAGEMENT

AMC 452381

CREDIT CARD PAYMENT
For Mining Claim Maintenance Fee

THIS IS A CHANGE OF ADDRESS

TELEPHONE SUBMISSION - ACCURACY OF THE BELOW INFORMATION IS THE RESPONSIBILITY OF THE CLAIMANT/OWNER

NAME Larry Johnson
ADDRESS P.O. BOX 1389
CITY SEWARD STATE ALASKA ZIP 99664
PHONE # 907 - 362-1133

Entered into LR2000 file

SEND RECEIPT TO Above address
 Other (Include Name and Mailing Address):

DO NOT UPDATE
Address per telephone conversation on 8/27/19. pb

AMC NUMBER
~~AMC 452382~~
AMC 452382

CLAIM/SITE NAME
ZOAC
GOLD ADVENTURE

ENTERED
AC 782 2020
AUG 27 2019
BY: PB

1 # of Claim/Site
x 165.00 Each
\$ 165 Total Charged PER (INITIALS)

RECEIPT # 4524983

DATE STAMP

RECEIVED
STATE OFFICE
2019 AUG -6 A 9:02
PHOENIX, ARIZONA

*transferred to the correct AMC #
AMC 45 2382*

**** FOR OFFICIAL USE ONLY ****

8-26-19

DATE _____ INITIALS _____ VERIFIED _____

ENTERED
AUG 18 2019
BY: [Signature]

United States Department of the Interior
Bureau of Land Management
 DIV OF LANDS, MINRLS & ENERGY
 ONE N CENTRAL AVE
 PHOENIX, AZ 85004 -4427
 Phone: 602-417-9200

Receipt	
No:	4524983

Transaction #: 4645697
Date of Transaction: 08/06/2019
CUSTOMER:
LARRY JOHNSON PO BOX 1389 SEWARD,AK 99664-1389 US

LINE #	QTY	DESCRIPTION	REMARKS	UNIT PRICE	TOTAL
1	1.00	LOCATABLE MINERALS / MINING CLAIMS- NOT NEW-UNADJUD,ONE AUTH NO. ONLY / MINING CLAIM MONEY RECEIVED CASES: AMC453382/\$165.00	2020 MAINT/1	- n/a -	165.00
TOTAL:					\$165.00

PAYMENT INFORMATION			
NOTE: Items will appear on credit card statement as "Bureau of Land Mgmt CO".			
1	AMOUNT:	165.00	POSTMARKED: N/A
	TYPE:	CREDIT CARD	RECEIVED: 08/06/2019
	NAME:	JOHNSON, LARRY PO BOX 1389 SEWARD AK 99664-1389 US	
	CARD NO:	XXXXXXXXXXXX0172	AUTH CODE: 06526D
	NAME ON CARD:	LARRY JOHNSON	
	SIGNATURE:		

REMARKS

This receipt was generated by the automated BLM Collections and Billing System and is a paper representation of a portion of the official electronic record contained therein.

Login ID2450
 Entry Date08/26/2019
 Total Amount\$165.00

Original Order Items

Line	Order#	AuthNos	TransDate	Action	Amount	CostCtr	R Org	BPD Year	Fund	FunctArea	WBS	Receipt Reference	CBS Bill#	Type	OrderItem
1	4645697	AMC453382	08/08/2019	MAINTENANCE FEE	\$165.00	LLAZ950000	LLAZ920000	2019	19XL1109HF	L19930000.RB0000				T	9295455

Order Items To Be Generated for Transfer

Line	Order#	AuthNos	TransDate	Action	Amount	CostCtr	R Org	BPD Year	Fund	FunctArea	WBS	Receipt Reference	CBS Bill#	Type	OrderItem
1	4645697	AMC453382	8/26/2019	MAINTENANCE FEE	\$-165.00	LLAZ950000	LLAZ920000	2019	19XL1109HF	L19930000.RB0000				T	9324010
2	4645697	AMC452382	8/26/2019	MINING CLAIM MONEY RECEIVED	\$165.00	LLAZ920000	LLAZ920000	2019	XXXL6500DP	L01130000.000000				T	9324011

correct ↑

DEPARTMENT OF THE INTERIOR
BUREAU OF LAND MANAGEMENT

Mining Claims

CUSTOMER INFORMATION

Admin State: AZ

Geo State: AZ

JOHNSON LARRY
16550 W ARROYO CT
SURPRISE AZ 85374-5102

Int Rel: CLAIMANT

Customer ID: 2440270

Serial Number	Lead Serial Number	Claim Name	County	D	Case Type	Last A Yr	Location Date	Meridian Township Range Section	Subdiv
AMC452382	AMC452381	GOLD ADVENTURE	YAVAPAI	A	PLACER	2019	10/10/2018	14 0080N 0050W 010	SE

**NO WARRANTY IS MADE BY BLM
FOR USE OF THE DATA FOR
PURPOSES NOT INTENDED BY BLM**

NOTICE!!

These documents have been scanned!

Do not place un-scanned documents beneath this notice!

Do not remove this notice from this file!

GPO Jacket No. 560-102
Print Order 61540
Rise Business Services, LLC
Job=AZ15 7/11/2019



Box Number= AZ15155



Claim Begin-End: AMC452381-AMC452383

5 Miscellaneous



AZ15155-9

AMC452349-AMC452348

TO: UNITED STATES DEPARTMENT OF THE INTERIOR
BUREAU OF LAND MANAGEMENT
ONE N. CENTRAL AVE SUITE 800
PHOENIX, AZ, 85004-4427

November 1st, 2018

3 NOTICE OF MINING LOCATIONS

Dear Bureau of Land Management,

Enclosed are 3 new Notice of Mining Locations. I would like to pay the \$636 (\$212 each) locating fees by credit card. Please give me a call once you have received this and I will be happy to get things taken care of and paid for over the phone.

Thanks!

Sincerely,

Noah Gordon
219-789-2433

Enclosed:
Notification letter
NOML for 'Crazy Horse'
NOML for 'Gold Adventure'
NOML for 'Gold Rush'

RECEIVED
BLM AZ STATE OFFICE
2018 NOV - 6 A 9 14
PHOENIX, ARIZONA

NOAH GORDON
P.O. Box 800
CONGRESS, AZ
85332

PHOENIX AZ 850

02 NOV 2016 FM 4 L



BUREAU OF LAND MANAGEMENT
ONE N. CENTRAL AVE SUITE# 800
PHOENIX, AZ
85004-4427

PHOENIX, ARIZONA

2016 NOV -6 A 9 14

RECEIVED
BLM AZ STATE OFFICE

85004-442700

NOTICE!!

These documents have been scanned!

Do not place un-scanned documents beneath this notice!

Do not remove this notice from this file!

GPO Jacket No. 560-102
Print Order 61540
Rise Business Services, LLC
Job=AZ15 7/11/2019



Box Number= AZ15155



Claim Begin-End: AMC452381-AMC452383

6 Location Notices-Amendments and Supporting Documents



AZ15155-9

AMC452349-AMC452348

MINING CLAIM STATUS REPORT

Data Entered: 11/15/2018

MTP Checked By: _____

GEO Checked By: _____

LEAD SERIAL NUMBER: AMC 452381 thru AMC 452383

NUMBER OF CLAIMS & TYPE:

3 LODE
PLACER
ASSOCIATION PLACER
MILL SITE
TUNNEL SITE

CHARGES:

Processing Fee @ \$20 = \$ 60
Location Fee @ \$37 = \$ 111
Maintenance Fee @ \$155 = \$ 465
Add'l Maint Fee for Assoc Placer = \$
SUBTOTAL \$
Other Fees \$
Other Fees \$
TOTAL \$ 636

TOTAL ACREAGE: _____ Per Claim
(Placer Only)

NUMBER OF LOCATORS: _____

DOCUMENTS RECEIVED VIA: Over-the-Counter [] Mail [X] TIMELY FILED: Yes [X] No []

LEGAL DESCRIPTION: T 8N R 5W SEC 10
T
T
T
T
T

BLM [] FOREST SERVICE [] SUBJ TO PL 359: Yes [] No []
WILDERNESS AREA []

SPLIT ESTATE: N/A [] SX [] PX [] OTHER []
SRHA [] Was proper Notice filed if located on SHRA Land? Yes [] No []

RECONVEYED MINERALS ON BLM LAND REQUIRE OPENING ORDER FROM 1944 TO 1993:

Open to Entry On _____ N/A []

COMMENTS/STATUS: VOID [] PARTIALLY VOID [] PVT MINERALS [] WITHDRAWN LANDS []
OTHER []

AMC 452381

[] Claimant acknowledges that portions of the following claim(s) site(s) may be void or voidable.

Printed Name of Claimant _____ Signature of Claimant _____

*****FINAL ADJUDICATION*****

DATE 6/3/2020 INITIALS AD

Noah Gordon
P.O. Box 800
Congress, AZ, 85332

LOCATION NOTICE FOR PLACER MINING CLAIM

Amendment BLM Serial # _____

NOTICE IS HEREBY GIVEN that the Crazy Horse
_____ placer mining claim has been located by
Noah Gordon whose current mailing
address is P.O. Box 800, Congress, AZ, 85332

BLM
Date
Stamp

RECEIVED
BLM AZ STATE OFFICE
2018 NOV -6 A 9 14
PHOENIX, ARIZONA

The general course of this claim is Rectangular N-S and it is situated in Yavapai
County, Arizona. This claim is 1320 feet in length and 660 feet in width.

20 Total Claim Acreage. This claim runs from the location monument on which this location notice is
posted at the NW corner of the claim approximately 660 feet in a Easterly direction to the
East end line and 1320 feet in a Southerly direction to the South end line. This claim is
marked by four monuments, one at each corner of the claim.

The location monument on which this notice is posted is situated within Section 10, Township
8 N, Range 5 W, Gila Salt River Base and Meridian, Arizona. This claim encompasses
portions of the following legal subdivision(s) if located by legal subdivision or the following quarter section(s),
section(s), Township(s) and Range(s) E1/2 SE1/4 SE1/4 SEC. 10 T8N R5W
_____, Gila Salt River Base and Meridian, Arizona.

The locality of this claim with reference to some natural object or permanent monument and additional information
(if any) concerning its locality are as follows: The SE corner of the claim is at the SE
corner of Section 10, T8N R5W, GSRB&M, AZ

_____ The above information is shown on the attached map.

DATED AND POSTED on the ground this 10TH day of OCTOBER, 20 18.

LOCATOR(s) AGENT

Print Name(s) Noah Gordon

Signature(s) 

Form MCF102
Revised July 2014

This form is available from the Arizona Geological Survey and may be reproduced.

AMC 452381

MINING CLAIM MAP

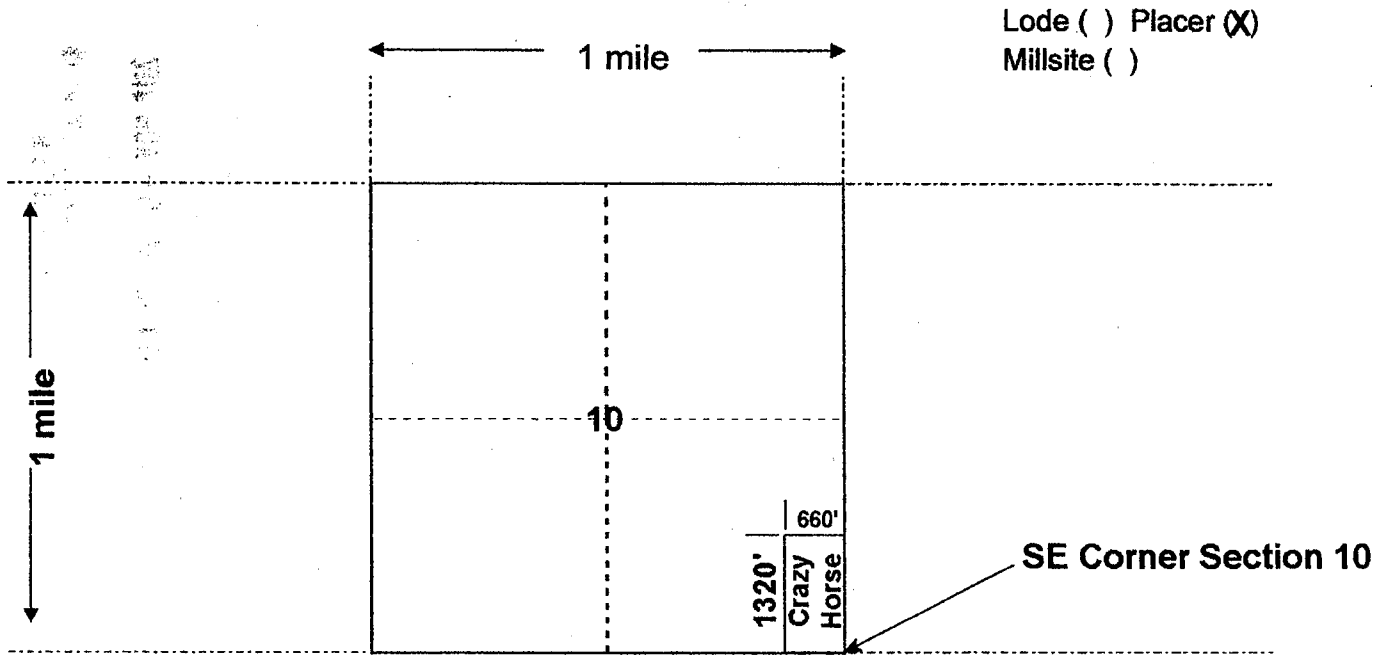

all corners are 90 degrees unless specified.

Scale: 1" = 2000 feet



1. The above map depicts the Crazy Horse mining claim, which is located in Section (s) 10, Township 8 N, Range 5 W, Gila and Salt River Base and Meridian, YAVAPAI County, Arizona. Total claim acreage is 20
2. The type of corner and location monuments used are as follows: 2"X5' Tall PVC pipe with aluminum name tag.
3. The bearings and distances in degrees and feet between claim corners and to a public land survey monument are as depicted on the map.
4. If the claim is a placer or millsite claim with exterior limits conforming to legal subdivisions of the public survey, provide a legal description of the claim E1/2SE1/4SE1/4 SEC. 10 T8NR5W, GSRB&M, AZ

Form MCF100a
Revised July 2014

This form is available from the Arizona Geology Survey and may be reproduced.

Noah Gordon
P.O. Box 800
Congress, AZ, 85332

LOCATION NOTICE FOR PLACER MINING CLAIM

Amendment BLM Serial # _____

NOTICE IS HEREBY GIVEN that the Gold Adventure
_____ placer mining claim has been located by
Noah Gordon whose current mailing
address is P.O. Box 800, Congress, AZ, 85332

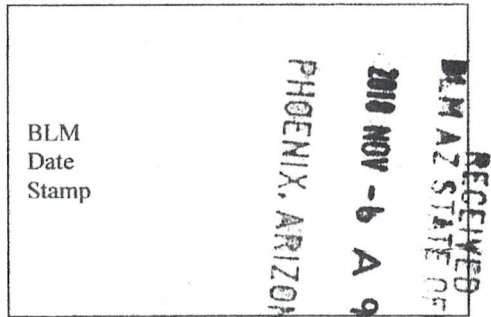

The general course of this claim is Rectangular N-S and it is situated in Yavapai
County, Arizona. This claim is 1320 feet in length and 660 feet in width.

20 Total Claim Acreage. This claim runs from the location monument on which this location notice is
posted at the NE corner of the claim approximately 1320 feet in a Southerly direction to the
South end line and 660 feet in a Westerly direction to the West end line. This claim is
marked by four monuments, one at each corner of the claim.

The location monument on which this notice is posted is situated within Section 10, Township
8 N, Range 5 W, Gila Salt River Base and Meridian, Arizona. This claim encompasses
portions of the following legal subdivision(s) if located by legal subdivision or the following quarter section(s),
section(s), Township(s) and Range(s) W1/2 SE1/4 SE1/4 SEC. 10 T8N R5W
_____, Gila Salt River Base and Meridian, Arizona.

The locality of this claim with reference to some natural object or permanent monument and additional information
(if any) concerning its locality are as follows: The SE corner of the claim is 660' West of
the SE corner of Section 10, T8N R5W, GSRB&M, AZ

_____ The above information is shown on the attached map.

DATED AND POSTED on the ground this 10TH day of OCTOBER, 20 18.

LOCATOR(s) AGENT

Print Name(s) Noah Gordon

Signature(s) [Handwritten Signature]

Form MCF102
Revised July 2014

AH0452382

MINING CLAIM MAP

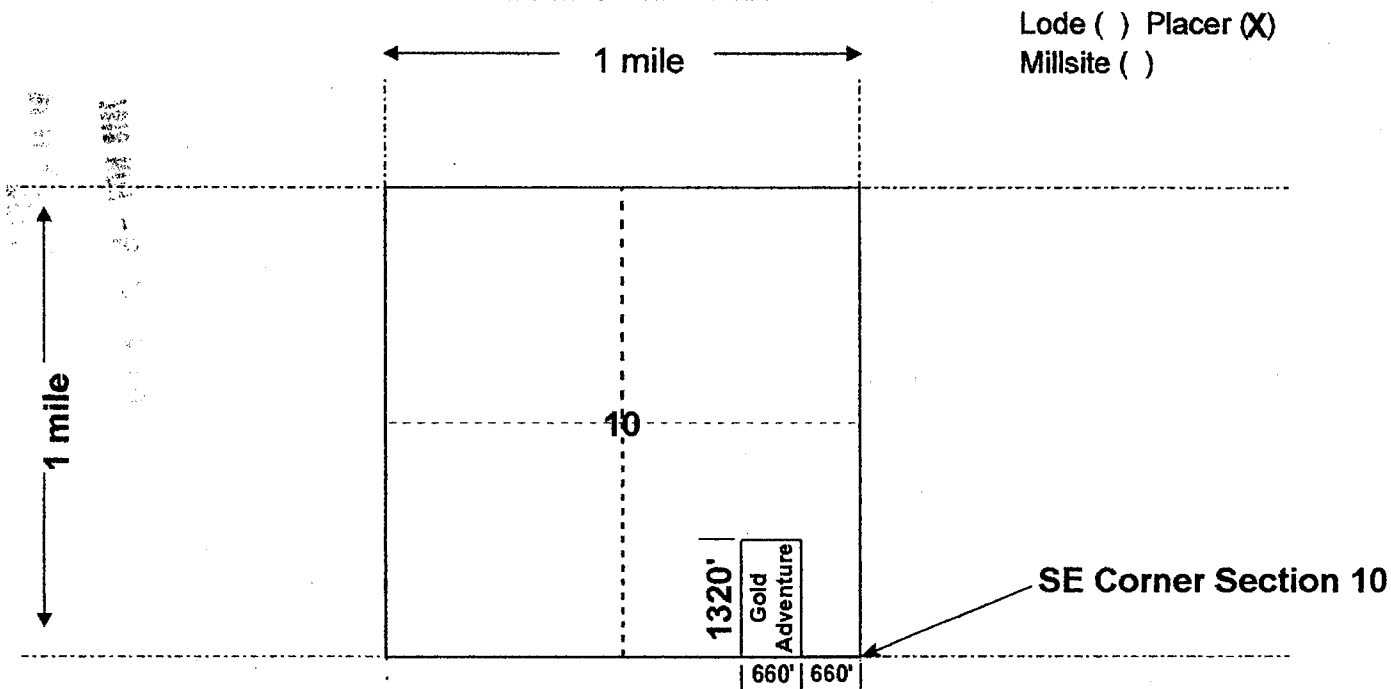

all corners are 90 degrees unless specified.

Scale: 1" = 2000 feet



1. The above map depicts the Gold Adventure mining claim, which is located in Section (s) 10, Township 8 N, Range 5 W, Gila and Salt River Base and Meridian, YAVAPAI County, Arizona. Total claim acreage is 20
2. The type of corner and location monuments used are as follows: 2"X5' Tall PVC pipe with aluminum name tag.
3. The bearings and distances in degrees and feet between claim corners and to a public land survey monument are as depicted on the map.
4. If the claim is a placer or millsite claim with exterior limits conforming to legal subdivisions of the public survey, provide a legal description of the claim W1/2SE1/4SE1/4 SEC. 10 T8NR5W, GSRB&M, AZ

Form MCF100a
Revised July 2014

This form is available from the Arizona Geology Survey and may be reproduced.

Noah Gordon
P.O. Box 800
Congress, AZ, 85332

LOCATION NOTICE FOR PLACER MINING CLAIM

Amendment BLM Serial # _____

NOTICE IS HEREBY GIVEN that the Gold Rush

_____ placer mining claim has been located by

Noah Gordon whose current mailing

address is P.O. Box 800, Congress, AZ, 85332

BLM
Date
Stamp

RECEIVED
BLM AZ STATE OFFICE
2018 NOV -6 A 9:14
PHOENIX, ARIZONA

The general course of this claim is Rectangular E-W and it is situated in Yavapai

County, Arizona. This claim is 1320 feet in length and 660 feet in width.

20 Total Claim Acreage. This claim runs from the location monument on which this location notice is

posted at the SW corner of the claim approximately 1320 feet in a Easterly direction to the

East end line and 660 feet in a Northerly direction to the North end line. This claim is

marked by four monuments, one at each corner of the claim.

The location monument on which this notice is posted is situated within Section 10, Township

8 N, Range 5 W, Gila Salt River Base and Meridian, Arizona. This claim encompasses

portions of the following legal subdivision(s) if located by legal subdivision or the following quarter section(s),

section(s), Township(s) and Range(s) S1/2 SW1/4 SE1/4 SEC. 10 T8N R5W

_____, Gila Salt River Base and Meridian, Arizona.

The locality of this claim with reference to some natural object or permanent monument and additional information

(if any) concerning its locality are as follows: The SE Corner of the claim is 1320' West

of the SE corner of Section 10, T8N R5W, GSRB&M, AZ

_____ The above information is shown on the attached map.

DATED AND POSTED on the ground this 10TH day of OCTOBER, 20 18.

LOCATOR(s) AGENT

Print Name(s) Noah Gordon

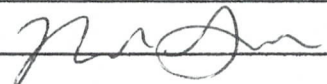
Signature(s) 

Form MCF102
Revised July 2014

This form is available from the Arizona Geological Survey and may be reproduced.

AHC452383

MINING CLAIM MAP

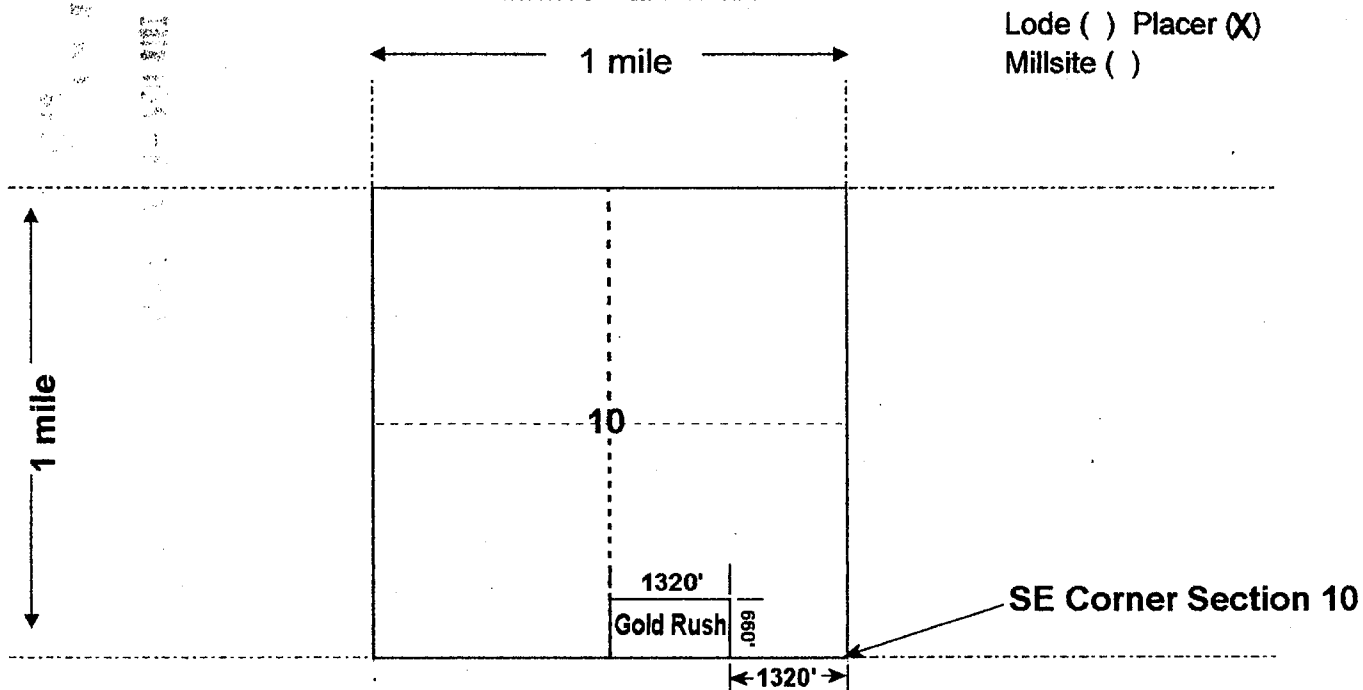

all corners are 90 degrees unless specified.

Scale: 1" = 2000 feet



1. The above map depicts the Gold Rush mining claim, which is located in Section (s) 10, Township 8 N, Range 5 W, Gila and Salt River Base and Meridian, YAVAPAI County, Arizona. Total claim acreage is 20

2. The type of corner and location monuments used are as follows: 2"X5' Tall PVC pipe with aluminum name tag.

3. The bearings and distances in degrees and feet between claim corners and to a public land survey monument are as depicted on the map.

4. If the claim is a placer or millsite claim with exterior limits conforming to legal subdivisions of the public survey, provide a legal description of the claim S1/2SW1/4SE1/4 SEC. 10 T8NR5W, GSRB&M, AZ

Form MCF100a
Revised July 2014

This form is available from the Arizona Geology Survey and may be reproduced.

